

dolphin

EXPORTS

AN ISO 9001-2015 CERTIFIED COMPANY

F- 343, Phase- 5, Focal Point,
Ludhiana - 141010, Punjab, India .

Ph. No.:- +91-161-5095142-43,
+91-98550-09019

Email:- info@dolphinexports.com,
mfg@dolphinexports.com

www.dolphinexports.com

Flange Model

INDEXING DRIVES

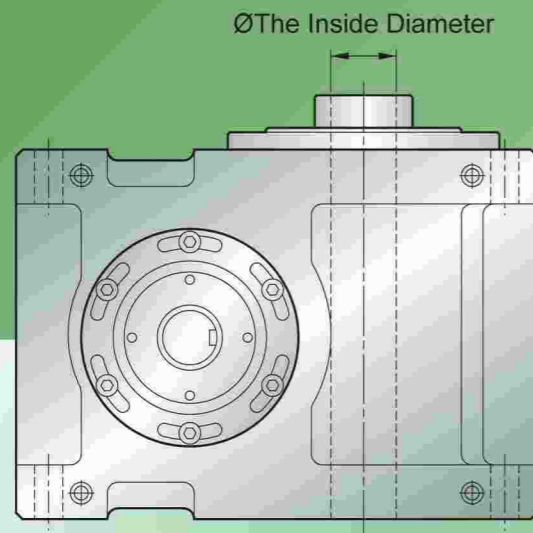

Flange Model- hollow size chart

Model Specifications	45F	60F	70F	80F	110F	140F	180F	250F
The Inside Diameter (mm)	Ø8	Ø17	Ø20	Ø30	Ø40	Ø52	Ø60	Ø80

※If not specified hollow, the output shaft is solid.(Standard)

DF 45DF, 60DF, 70DF, 80DF, 110DF, 140DF, 180DF, 250DF

This type, we have researched and developed for a long time which has high rigidity and various connections to tables, gears, sprockets and the other peripherals placed onto the output shaft face where in the center a hollow is provided to enable the connection with a foreign shaft as well.

In addition, the well-designed housings of this ensure an easy handling installation.

Ever sensitive to the users' needs, we can assure that our index drives will satisfy those engaged in the assembly work.

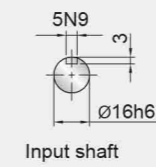
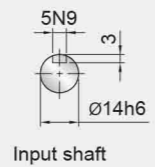
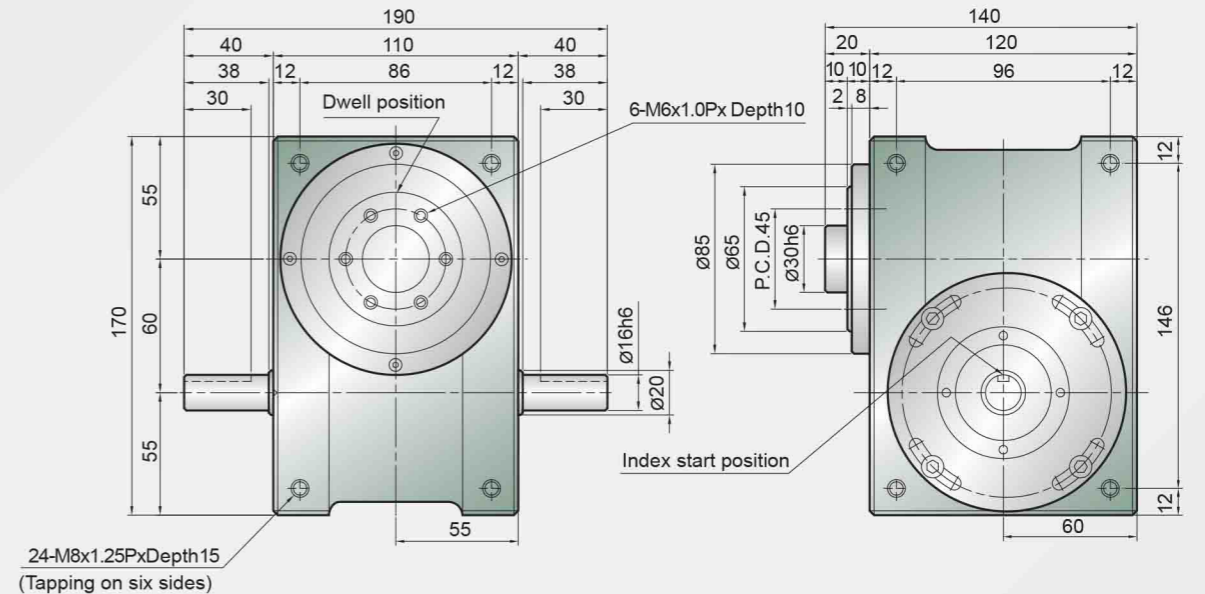
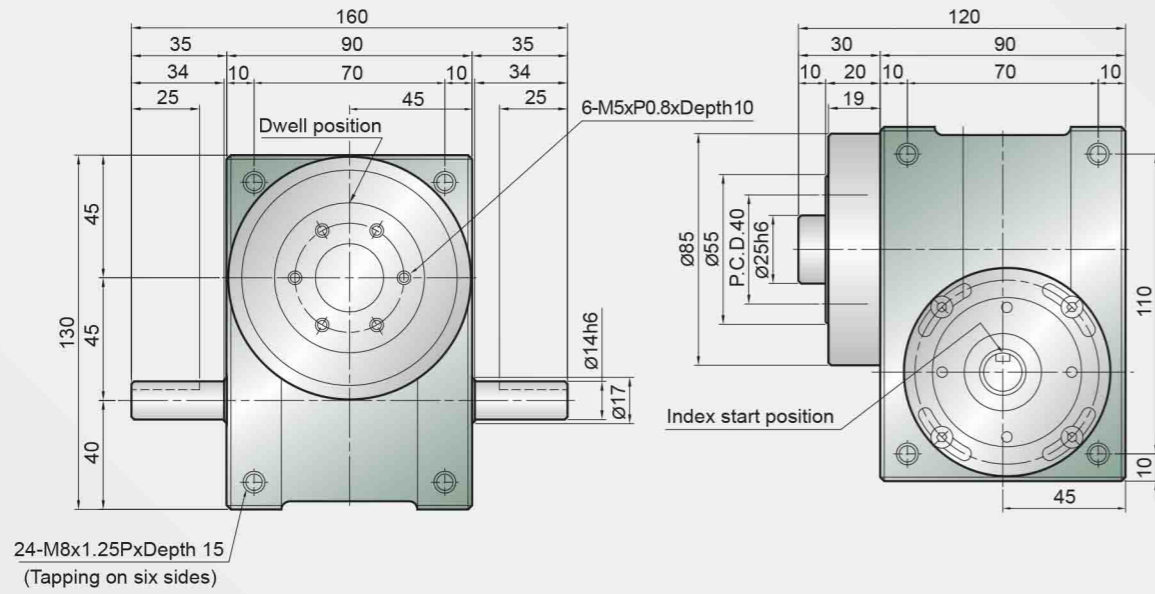

45DF

60DF

Item	Sym-bol	Unit	Value
Allowable thrust load on output shaft	C1	kgf	130
Allowable radial load on output shaft	C2	kgf	140
Allowable torque on output shaft	Ts	kgf-m	Refer torque table
Allowable thrust load on input shaft	C3	kgf	85
Max. repetitive bending force on input shaft	C4	kgf	110
Max. repetitive torque on input shaft	C5	kgf-m	4
GD ² of input shaft (Note1)	C6	kgf-m ²	3.2 x 10 ⁻⁴
Indexing accuracy		sec.	±60
Weight		kg	7

Notes
 1) GD² of input shaft is a value in dwell range.
 2) Value of C1 to C5 are those obtained for safety factor=2.

Item	Sym-bol	Unit	Value
Allowable thrust load on output shaft	C1	kgf	140
Allowable radial load on output shaft	C2	kgf	142
Allowable torque on output shaft	Ts	kgf-m	Refer torque table
Allowable thrust load on input shaft	C3	kgf	100
Max. repetitive bending force on input shaft	C4	kgf	150
Max. repetitive torque on input shaft	C5	kgf-m	6
GD ² of input shaft (Note1)	C6	kgf-m ²	1.9 x 10 ⁻³
Indexing accuracy		sec.	±45
Weight		kg	13

Notes
 1) GD² of input shaft is a value in dwell range.
 2) Value of C1 to C5 are those obtained for safety factor=2.

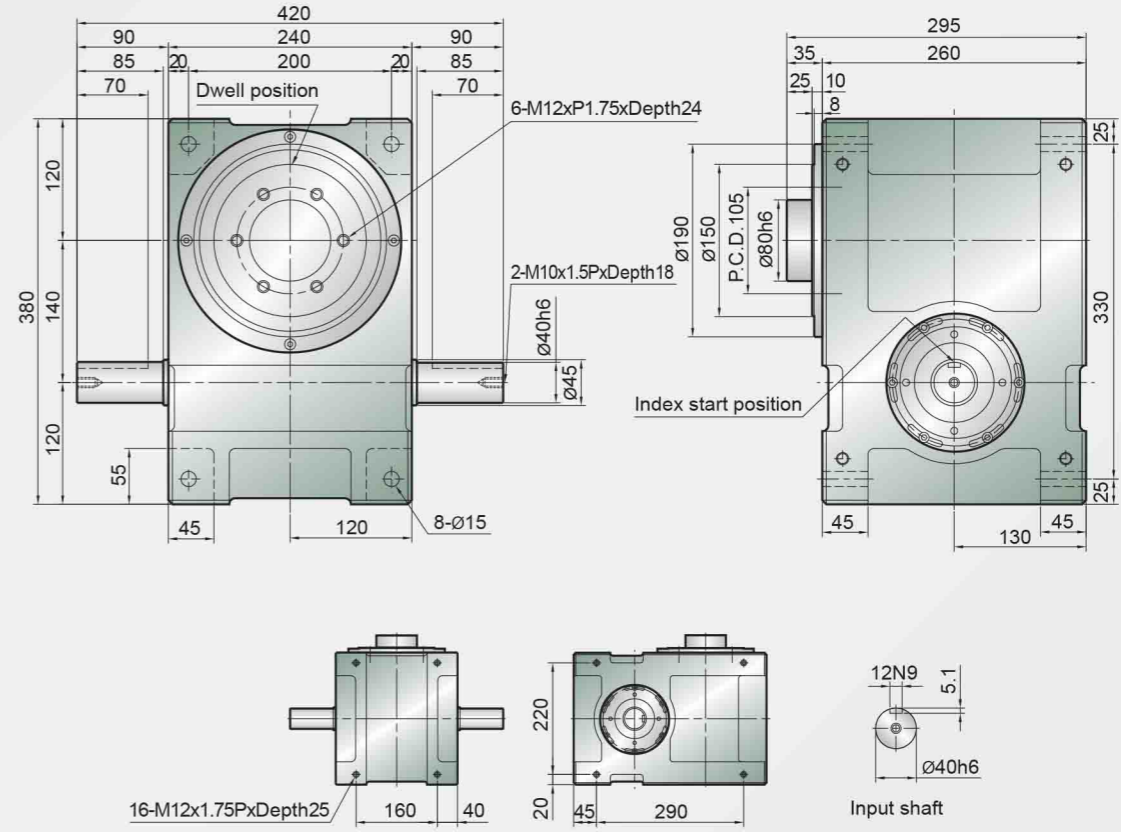
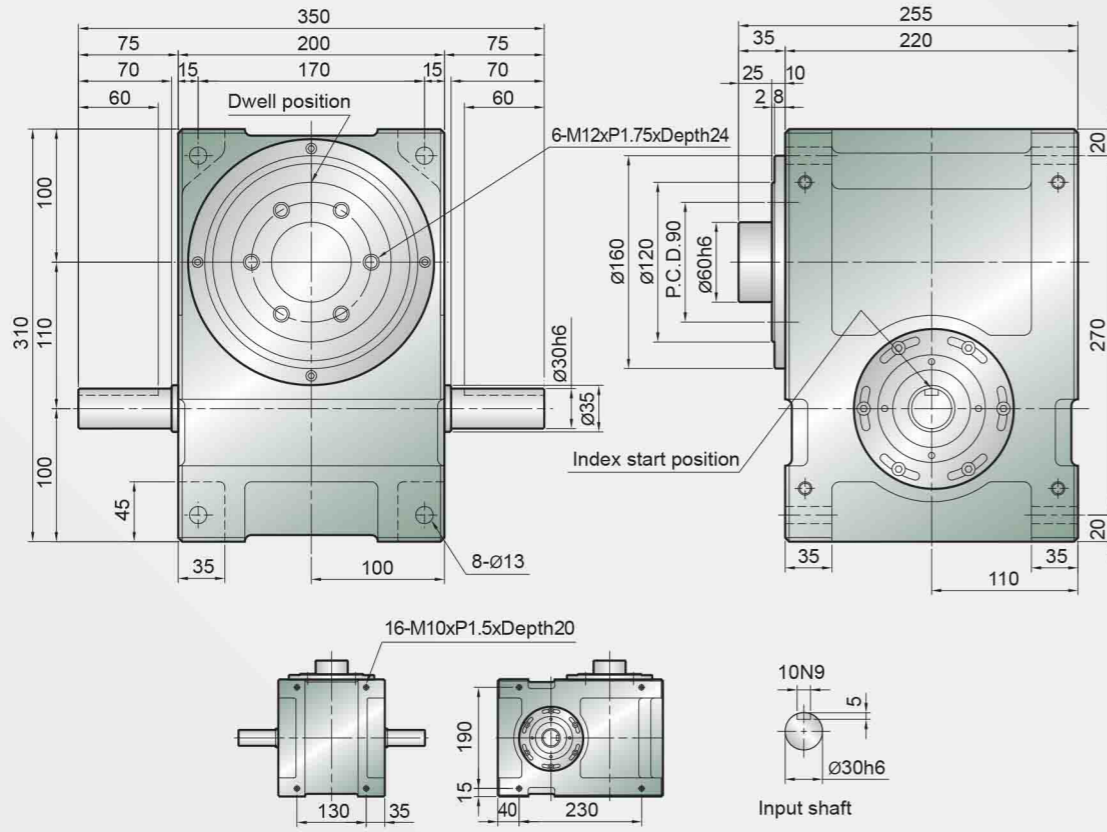

Item	Sym-bol	Unit	Value
Allowable thrust load on output shaft	C1	kgf	560
Allowable radial load on output shaft	C2	kgf	700
Allowable torque on output shaft	Ts	kgf-m	Refer torque table
Allowable thrust load on input shaft	C3	kgf	480
Max. repetitive bending force on input shaft	C4	kgf	415
Max. repetitive torque on input shaft	C5	kgf-m	40
GD ² of input shaft (Note1)	C6	kgf-m ²	2.8 x 10 ⁻²
Indexing accuracy		sec.	±30
Weight		kg	65

Notes
 1) GD² of input shaft is a value in dwell range.
 2) Value of C1 to C5 are those obtained for safety factor=2.

Item	Sym-bol	Unit	Value
Allowable thrust load on output shaft	C1	kgf	760
Allowable radial load on output shaft	C2	kgf	1000
Allowable torque on output shaft	Ts	kgf-m	Refer torque table
Allowable thrust load on input shaft	C3	kgf	550
Max. repetitive bending force on input shaft	C4	kgf	710
Max. repetitive torque on input shaft	C5	kgf-m	100
GD ² of input shaft (Note1)	C6	kgf-m ²	0.11
Indexing accuracy		sec.	±30
Weight		kg	90

Notes
 1) GD² of input shaft is a value in dwell range.
 2) Value of C1 to C5 are those obtained for safety factor=2.

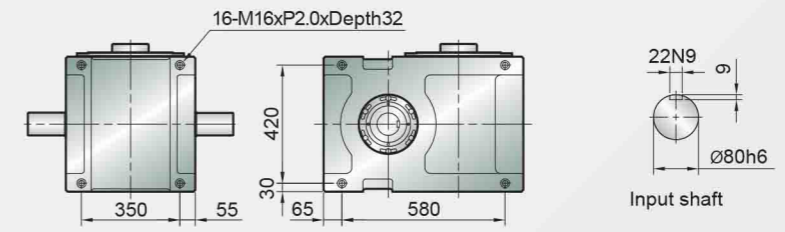
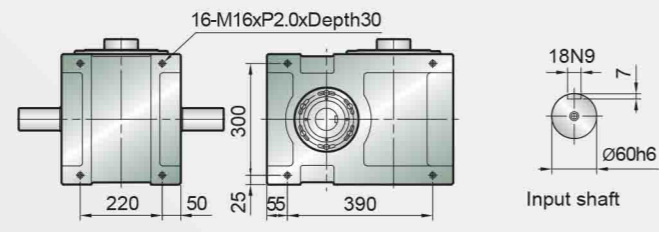
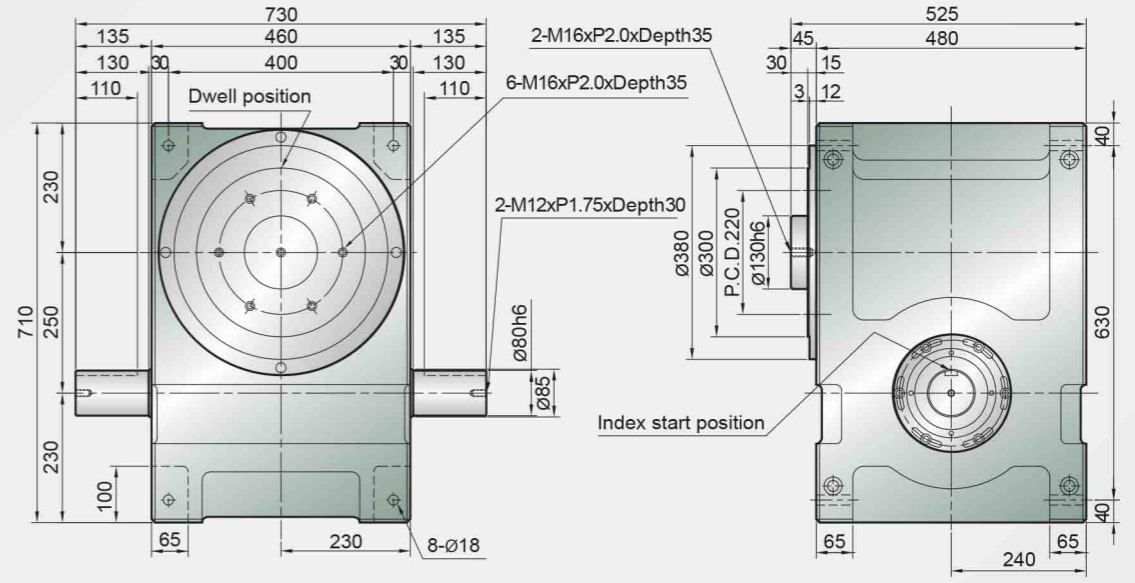
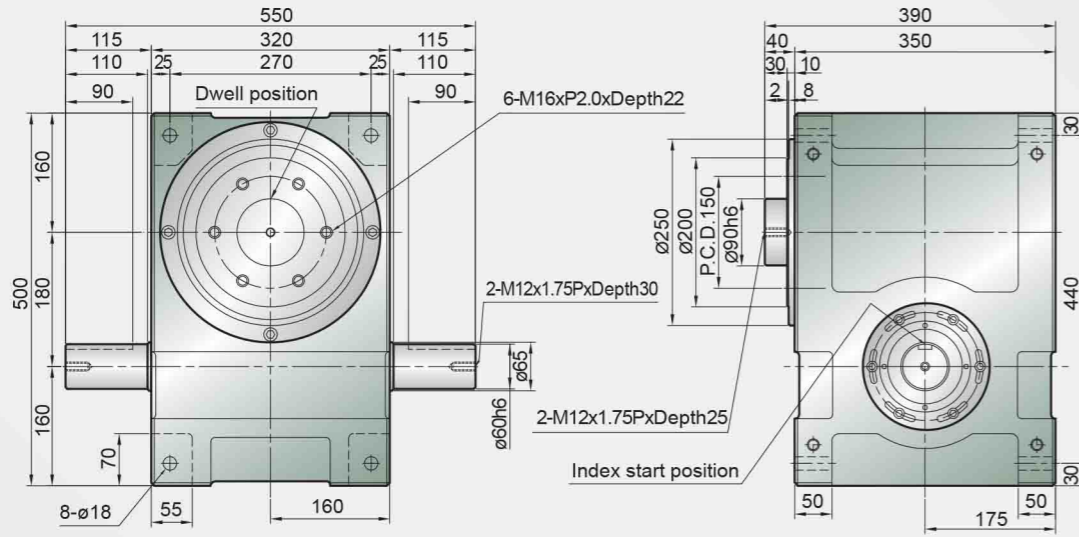

Item	Sym-bol	Unit	Value
Allowable thrust load on output shaft	C1	kgf	1200
Allowable radial load on output shaft	C2	kgf	1500
Allowable torque on output shaft	Ts	kgf-m	Refer torque table
Allowable thrust load on input shaft	C3	kgf	1100
Max. repetitive bending force on input shaft	C4	kgf	1960
Max. repetitive torque on input shaft	C5	kgf-m	340
GD ² of input shaft (Note1)	C6	kgf-m ²	0.39
Indexing accuracy		sec.	±30
Weight		kg	220

Notes
 1) GD² of input shaft is a value in dwell range.
 2) Value of C1 to C5 are those obtained for safety factor=2.

Item	Sym-bol	Unit	Value
Allowable thrust load on output shaft	C1	kgf	3200
Allowable radial load on output shaft	C2	kgf	4150
Allowable torque on output shaft	Ts	kgf-m	Refer torque table
Allowable thrust load on input shaft	C3	kgf	1550
Max. repetitive bending force on input shaft	C4	kgf	3800
Max. repetitive torque on input shaft	C5	kgf-m	780
GD ² of input shaft (Note1)	C6	kgf-m ²	1.98
Indexing accuracy		sec.	±30
Weight		kg	685

Notes
 1) GD² of input shaft is a value in dwell range.
 2) Value of C1 to C5 are those obtained for safety factor=2.

Table Model

INDEXING DRIVES

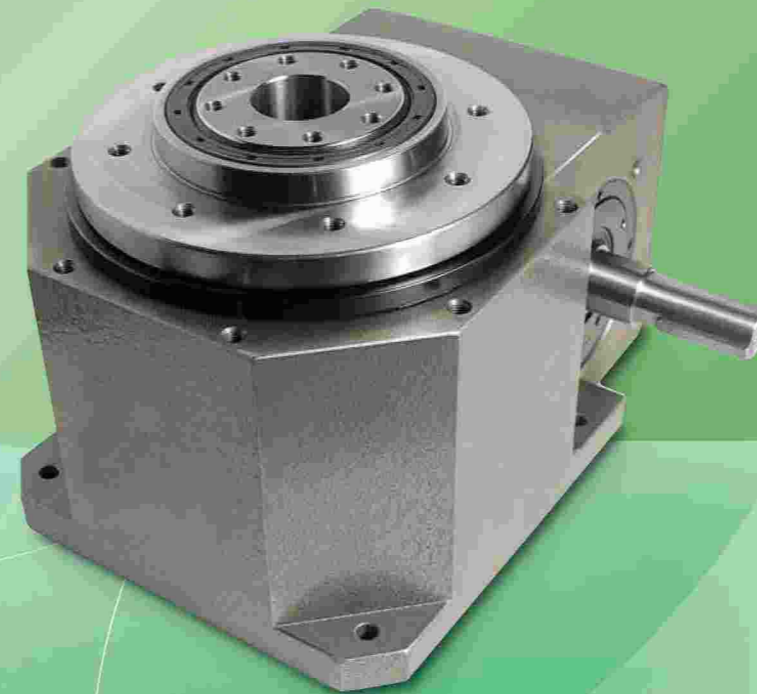

DT 80DT, 110DT, 140DT, 180DT,
210DT, 250DT,

This is one of the fully-developed table type index drives, which has high rigidity because of the adoption of a wider and lower table in whose center a tough hollow shaft is employed. This housing is so designed that an attachment can be installed on its sides, therefore, it is most suitable to rotary automatic assemblers, transfer machines and automatic wrappers.

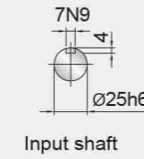
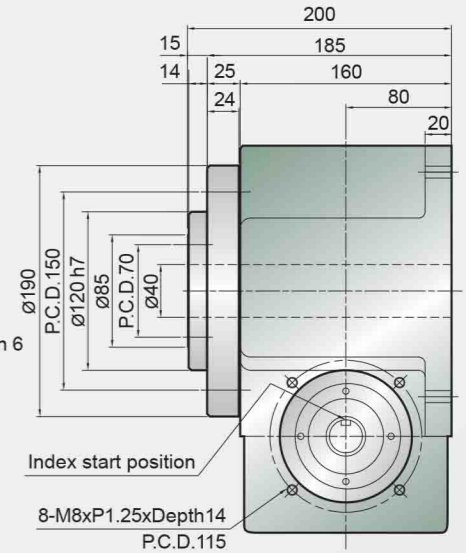
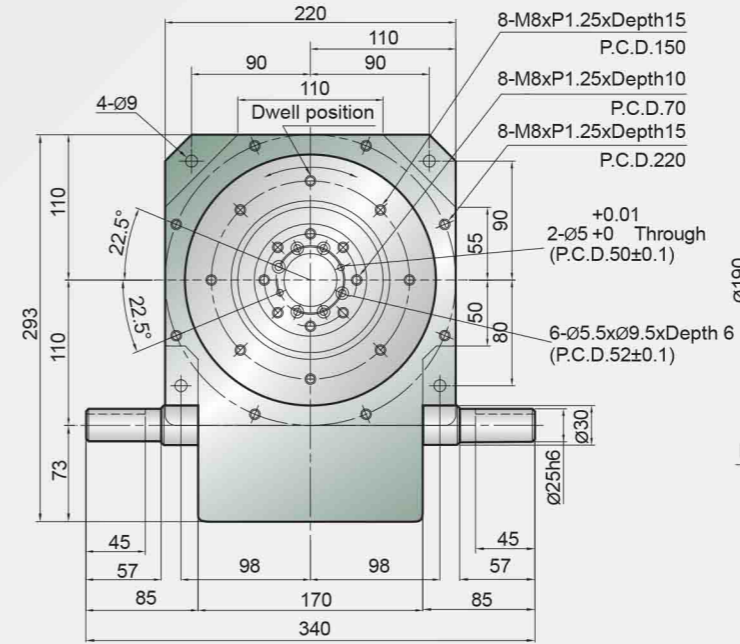
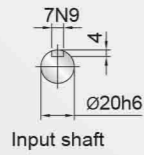
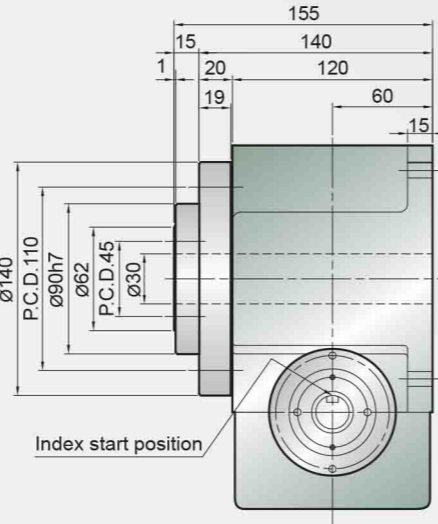
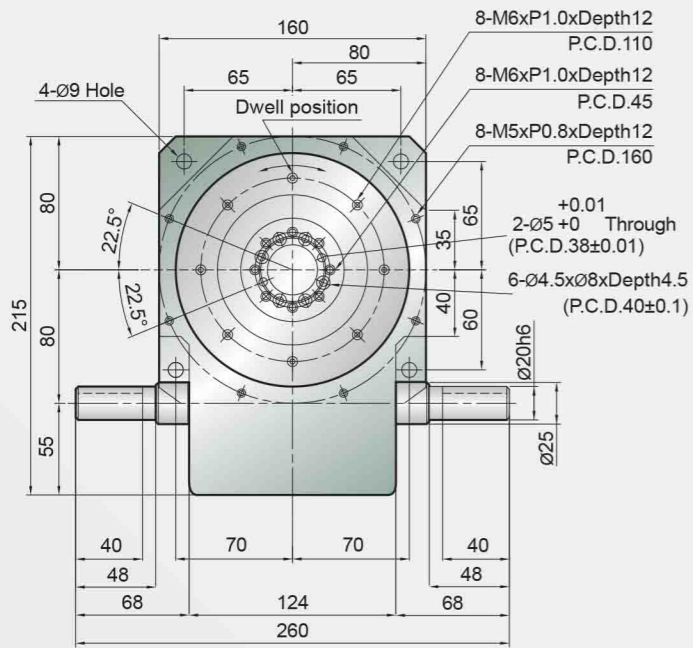

Item	Sym-bol	Unit	Value
Allowable thrust load on output shaft	C1	kgf	520
Allowable radial load on output shaft	C2	kgf	220
Allowable torque on output shaft	Ts	kgf-m	Refer torque table
Allowable thrust load on input shaft	C3	kgf	220
Max. repetitive bending force on input shaft	C4	kgf	160
Max. repetitive torque on input shaft	C5	kgf-m	9.5
GD ² of input shaft (Note1)	C6	kgf-m ²	0.03
Indexing accuracy		sec.	±30
Weight		kg	20

Notes
 1) GD² of input shaft is a value in dwell range.
 2) Value of C1 to C5 are those obtained for safety factor=2.

Item	Sym-bol	Unit	Value
Allowable thrust load on output shaft	C1	kgf	860
Allowable radial load on output shaft	C2	kgf	420
Allowable torque on output shaft	Ts	kgf-m	Refer torque table
Allowable thrust load on input shaft	C3	kgf	300
Max. repetitive bending force on input shaft	C4	kgf	250
Max. repetitive torque on input shaft	C5	kgf-m	25
GD ² of input shaft (Note1)	C6	kgf-m ²	0.01
Indexing accuracy		sec.	±30
Weight		kg	50

Notes
 1) GD² of input shaft is a value in dwell range.
 2) Value of C1 to C5 are those obtained for safety factor=2.

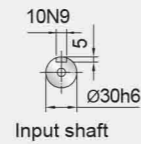
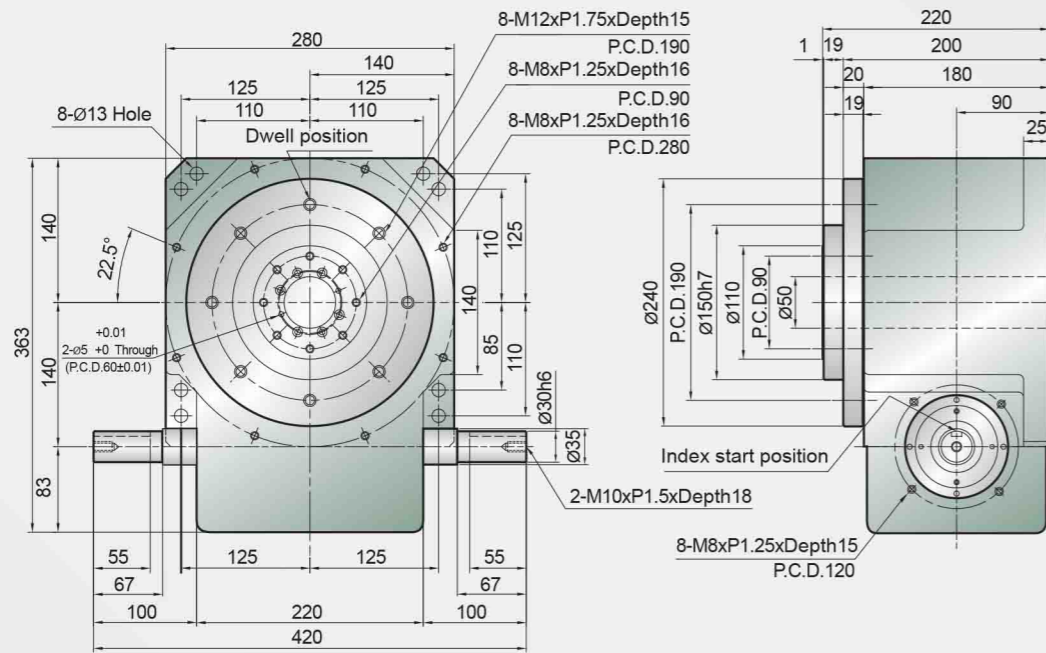

Input shaft

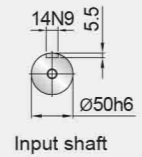
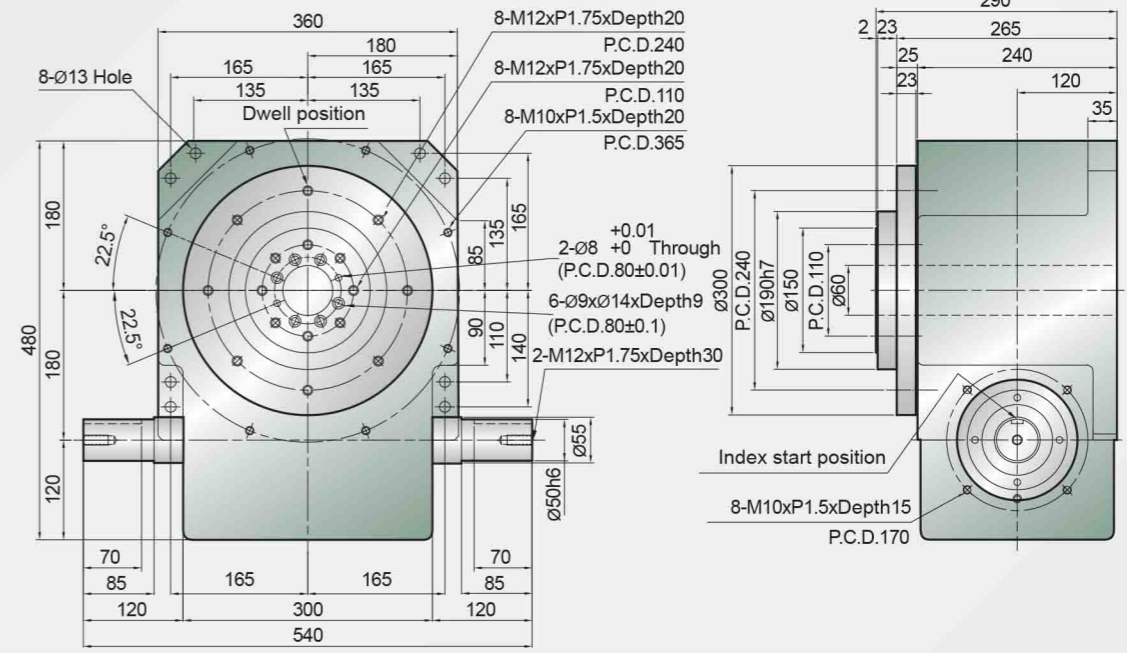

Input shaft

Item	Sym-bol	Unit	Value
Allowable thrust load on output shaft	C1	kgf	1050
Allowable radial load on output shaft	C2	kgf	720
Allowable torque on output shaft	Ts	kgf-m	Refer torque table
Allowable thrust load on input shaft	C3	kgf	500
Max. repetitive bending force on input shaft	C4	kgf	350
Max. repetitive torque on input shaft	C5	kgf-m	53
GD ² of input shaft (Note1)	C6	kgf-m ²	0.07
Indexing accuracy		sec.	±30
Weight		kg	85

Notes

1) GD² of input shaft is a value in dwell range.

2) Value of C1 to C5 are those obtained for safety factor=2.

Item	Sym-bol	Unit	Value
Allowable thrust load on output shaft	C1	kgf	1500
Allowable radial load on output shaft	C2	kgf	1100
Allowable torque on output shaft	Ts	kgf-m	Refer torque table
Allowable thrust load on input shaft	C3	kgf	1200
Max. repetitive bending force on input shaft	C4	kgf	960
Max. repetitive torque on input shaft	C5	kgf-m	220
GD ² of input shaft (Note1)	C6	kgf-m ²	0.23
Indexing accuracy		sec.	±30
Weight		kg	190

Notes

1) GD² of input shaft is a value in dwell range.

2) Value of C1 to C5 are those obtained for safety factor=2.

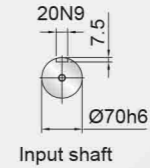
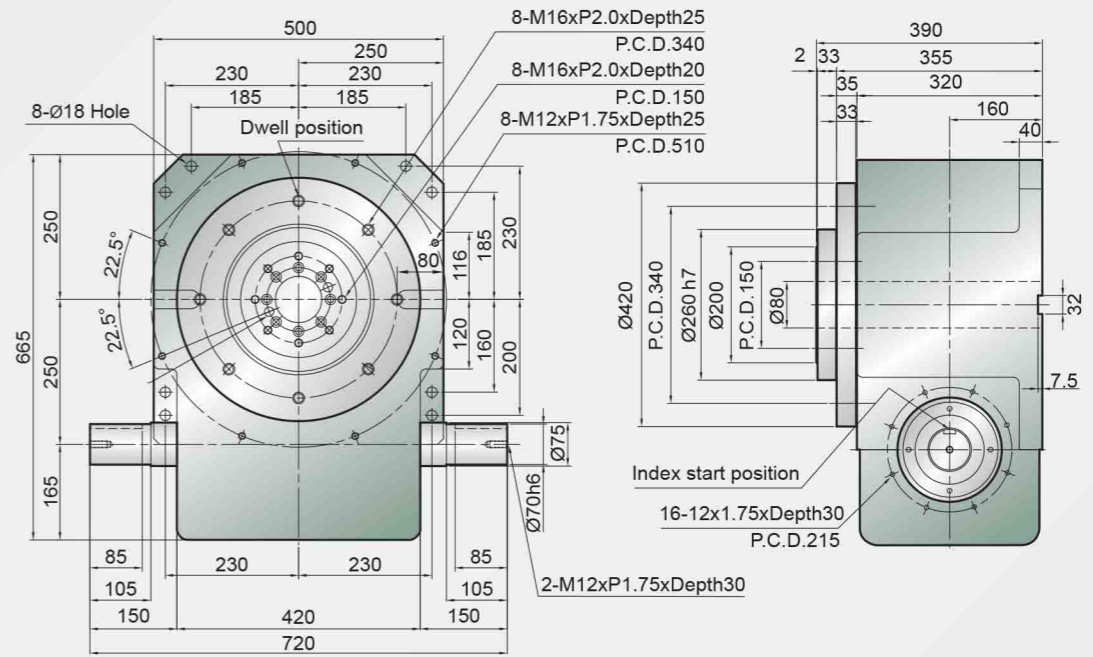
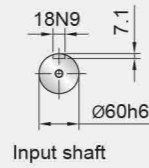
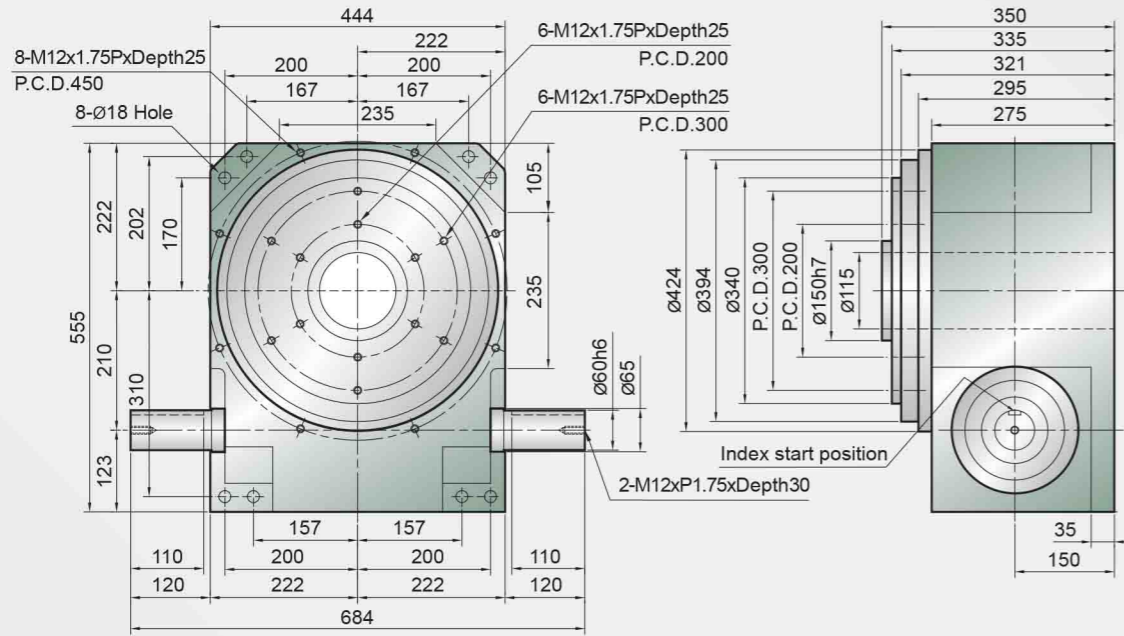

Item	Sym-bol	Unit	Value
Allowable thrust load on output shaft	C1	kgf	1950
Allowable radial load on output shaft	C2	kgf	1520
Allowable torque on output shaft	Ts	kgf-m	Refer torque table
Allowable thrust load on input shaft	C3	kgf	1570
Max. repetitive bending force on input shaft	C4	kgf	1130
Max. repetitive torque on input shaft	C5	kgf-m	460
GD ² of input shaft (Note1)	C6	kgf-m ² 0.62	
Indexing accuracy		sec.	±30
Weight		kg	450

Notes
 1) GD² of input shaft is a value in dwell range.
 2) Value of C1 to C5 are those obtained for safety factor=2.

Item	Sym-bol	Unit	Value
Allowable thrust load on output shaft	C1	kgf	2500
Allowable radial load on output shaft	C2	kgf	1800
Allowable torque on output shaft	Ts	kgf-m	Refer torque table
Allowable thrust load on input shaft	C3	kgf	1900
Max. repetitive bending force on input shaft	C4	kgf	2250
Max. repetitive torque on input shaft	C5	kgf-m	670
GD ² of input shaft (Note1)	C6	kgf-m ²	0.86
Indexing accuracy		sec.	±30
Weight		kg	500

Notes
 1) GD² of input shaft is a value in dwell range.
 2) Value of C1 to C5 are those obtained for safety factor=2.

Ultrathin Table Model

INDEXING DRIVES



DA 70DA, 90DA, 110DA, 150DA,
190DA, 230DA,

The properties of the series are the same as the table model. It could be endured the heavy axial and radial load. The necessary equipment would be assembled directly to the flange and large diameter hollow shaft of the output of the series. Electric wire and pipe from the power source could be passed through the hollow shaft. The series are widely applied in automation apparatus and industrial machinery to work the intermittent motion.

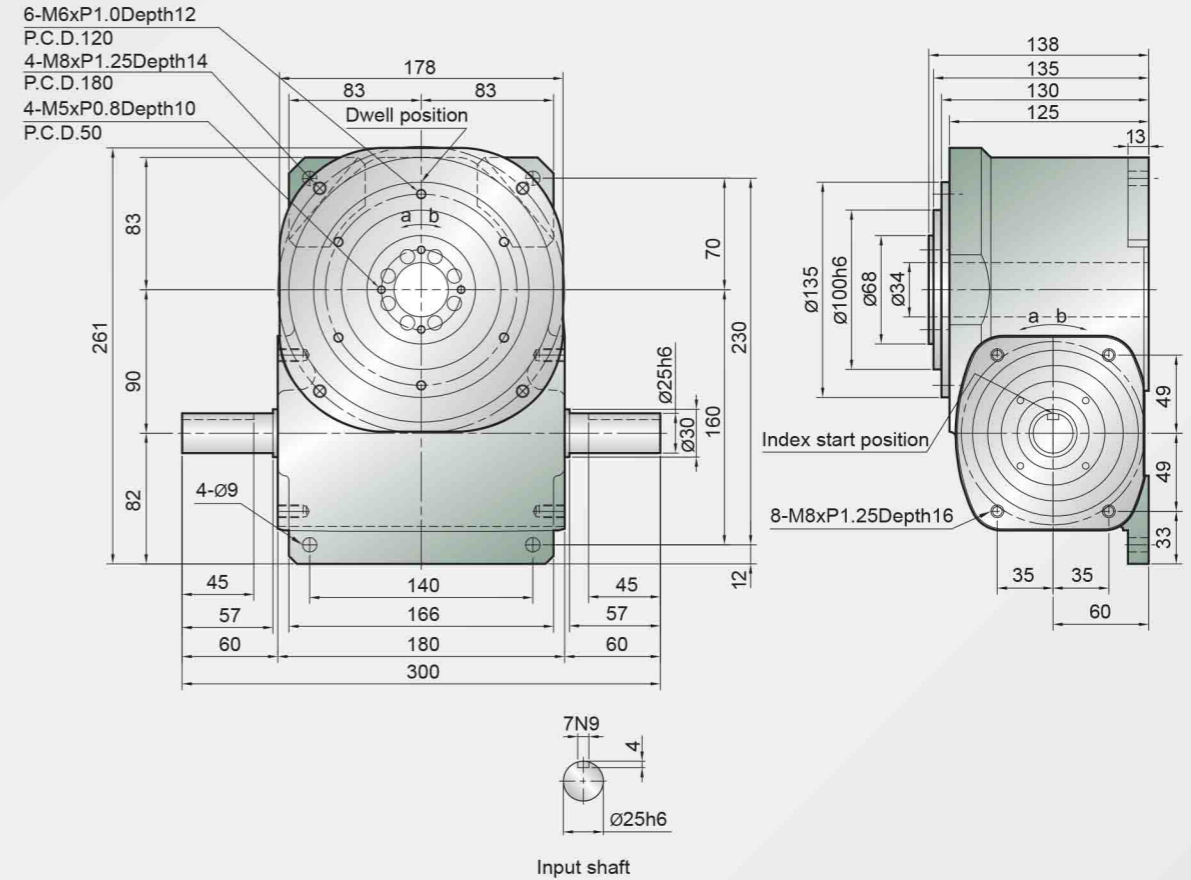
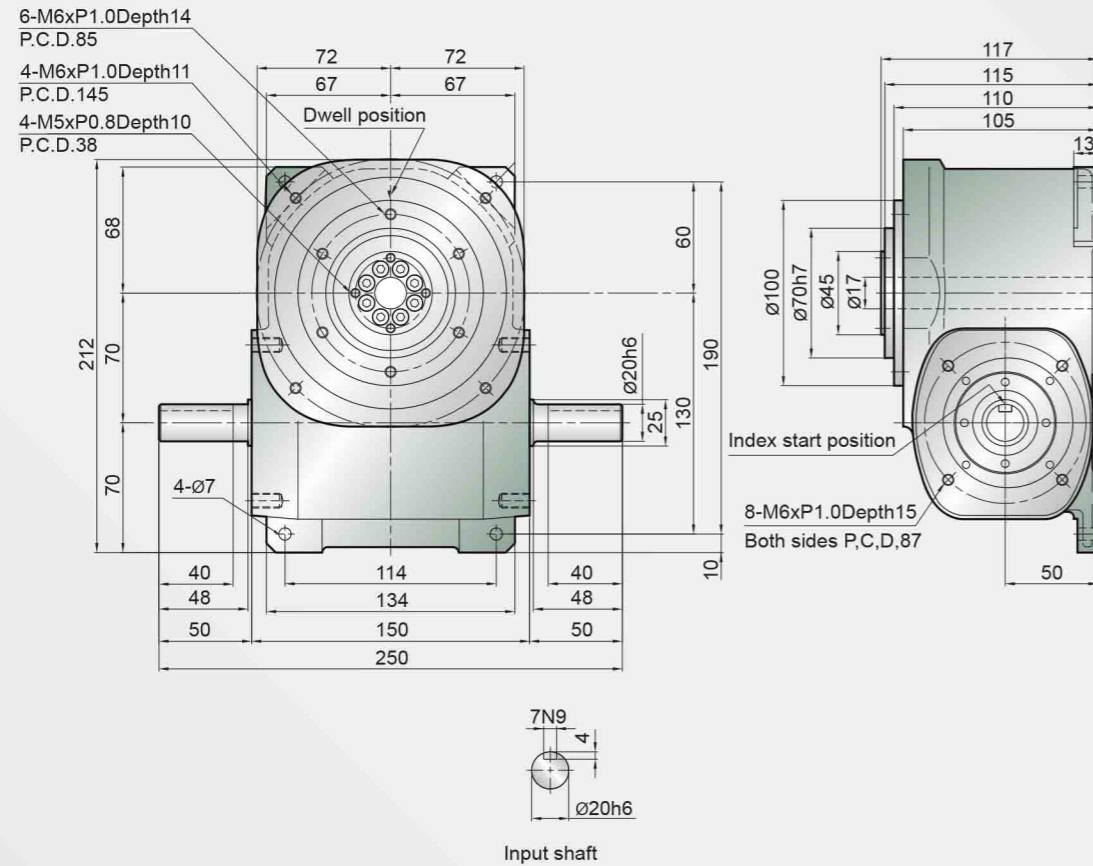

Item	Sym-bol	Unit	Value
Allowable thrust load on output shaft	C1	kgf	316
Allowable radial load on output shaft	C2	kgf	142
Allowable torque on output shaft	Ts	kgf-m	Refer torque table
Allowable thrust load on input shaft	C3	kgf	190
Max. repetitive bending force on input shaft	C4	kgf	163
Max. repetitive torque on input shaft	C5	kgf-m	9.5
GD ² of input shaft (Note1)	C6	kgf-m ²	1.9 x 10 ⁻³
Indexing accuracy		sec.	±30
Weight		kg	15

Notes
1) GD² of input shaft is a value in dwell range.
2) Value of C1 to C5 are those obtained for safety factor=2.

Item	Sym-bol	Unit	Value
Allowable thrust load on output shaft	C1	kgf	500
Allowable radial load on output shaft	C2	kgf	210
Allowable torque on output shaft	Ts	kgf-m	Refer torque table
Allowable thrust load on input shaft	C3	kgf	260
Max. repetitive bending force on input shaft	C4	kgf	260
Max. repetitive torque on input shaft	C5	kgf-m	25
GD ² of input shaft (Note1)	C6	kgf-m ²	2.5 x 10 ⁻³
Indexing accuracy		sec.	±30
Weight		kg	28

Notes
1) GD² of input shaft is a value in dwell range.
2) Value of C1 to C5 are those obtained for safety factor=2.

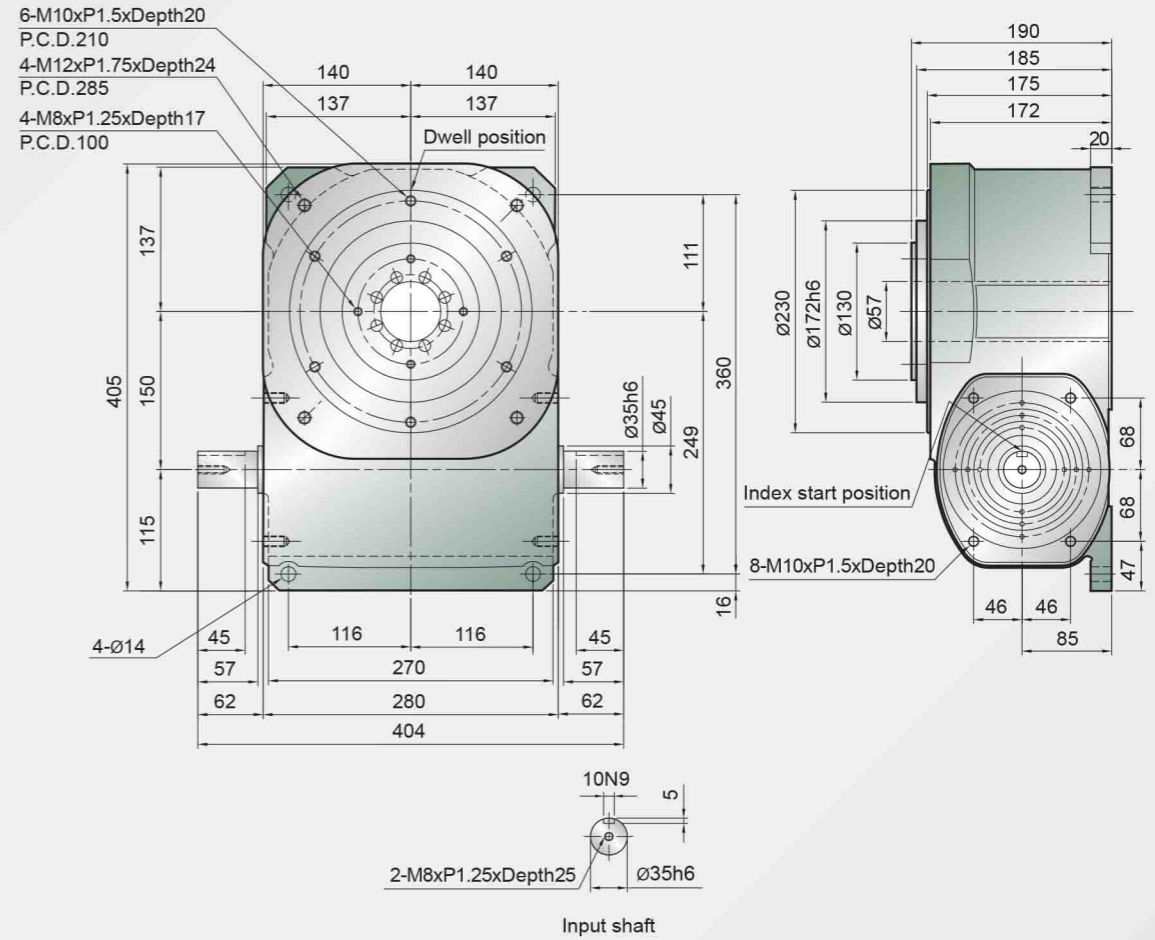
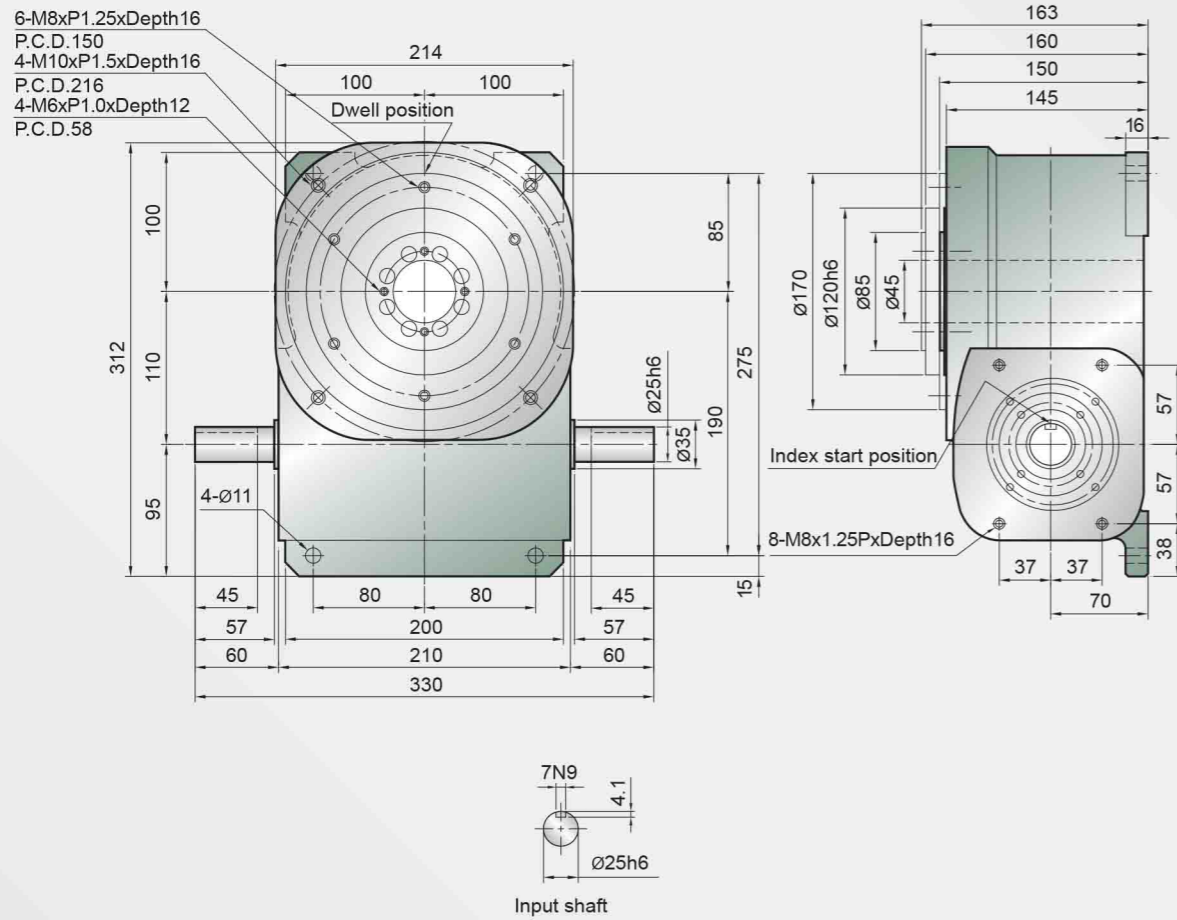

Item	Sym-bol	Unit	Value
Allowable thrust load on output shaft	C1	kgf	700
Allowable radial load on output shaft	C2	kgf	350
Allowable torque on output shaft	Ts	kgf-m	Refer torque table
Allowable thrust load on input shaft	C3	kgf	310
Max. repetitive bending force on input shaft	C4	kgf	360
Max. repetitive torque on input shaft	C5	kgf-m	30
GD ² of input shaft (Note1)	C6	kgf-m ²	6.0 x 10 ⁻³
Indexing accuracy		sec.	±30
Weight		kg	42

Notes
1) GD² of input shaft is a value in dwell range.
2) Value of C1 to C5 are those obtained for safety factor=2.

Item	Sym-bol	Unit	Value
Allowable thrust load on output shaft	C1	kgf	1200
Allowable radial load on output shaft	C2	kgf	700
Allowable torque on output shaft	Ts	kgf-m	Refer torque table
Allowable thrust load on input shaft	C3	kgf	410
Max. repetitive bending force on input shaft	C4	kgf	410
Max. repetitive torque on input shaft	C5	kgf-m	40
GD ² of input shaft (Note1)	C6	kgf-m ²	0.02
Indexing accuracy		sec.	±30
Weight		kg	86

Notes
1) GD² of input shaft is a value in dwell range.
2) Value of C1 to C5 are those obtained for safety factor=2.

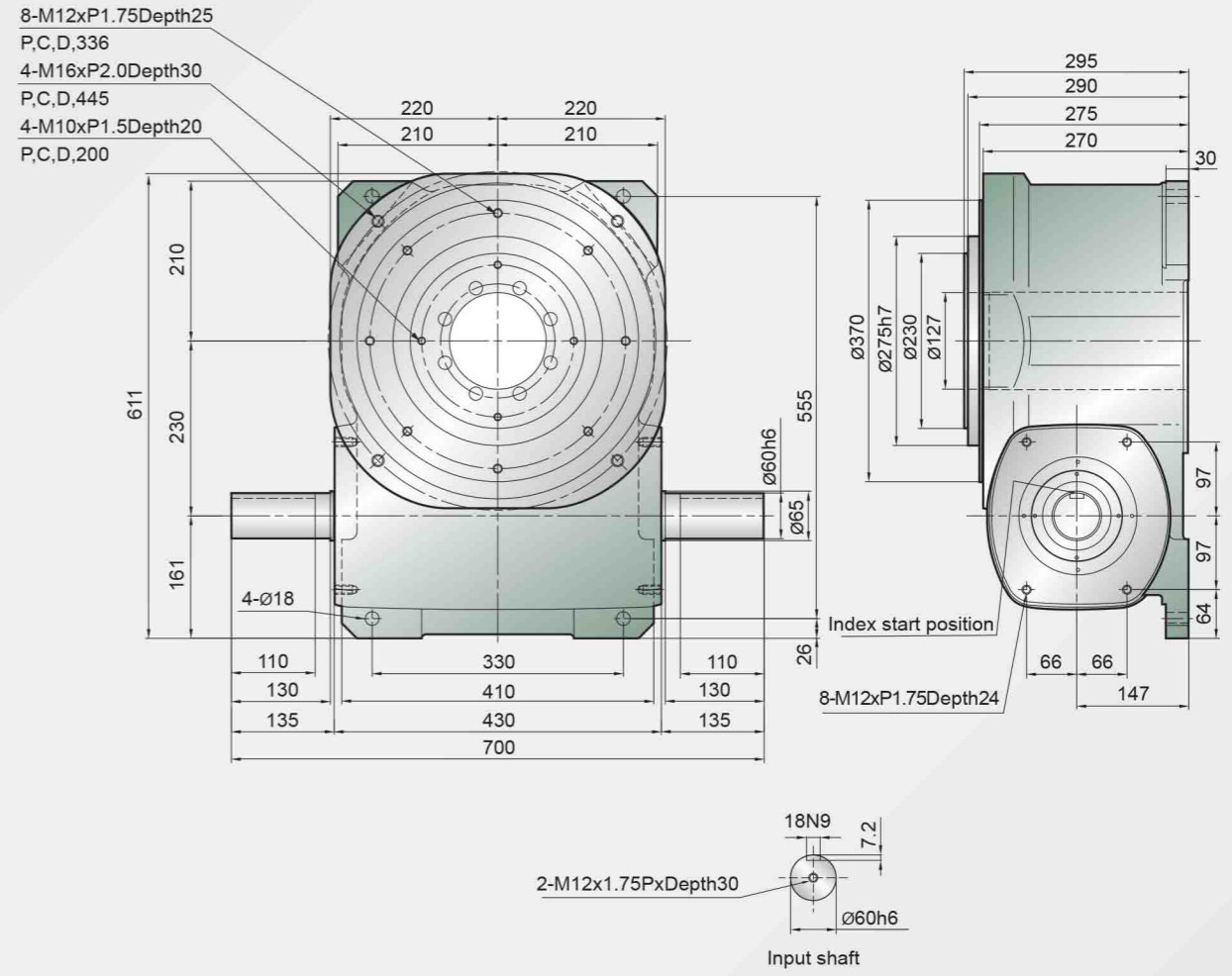
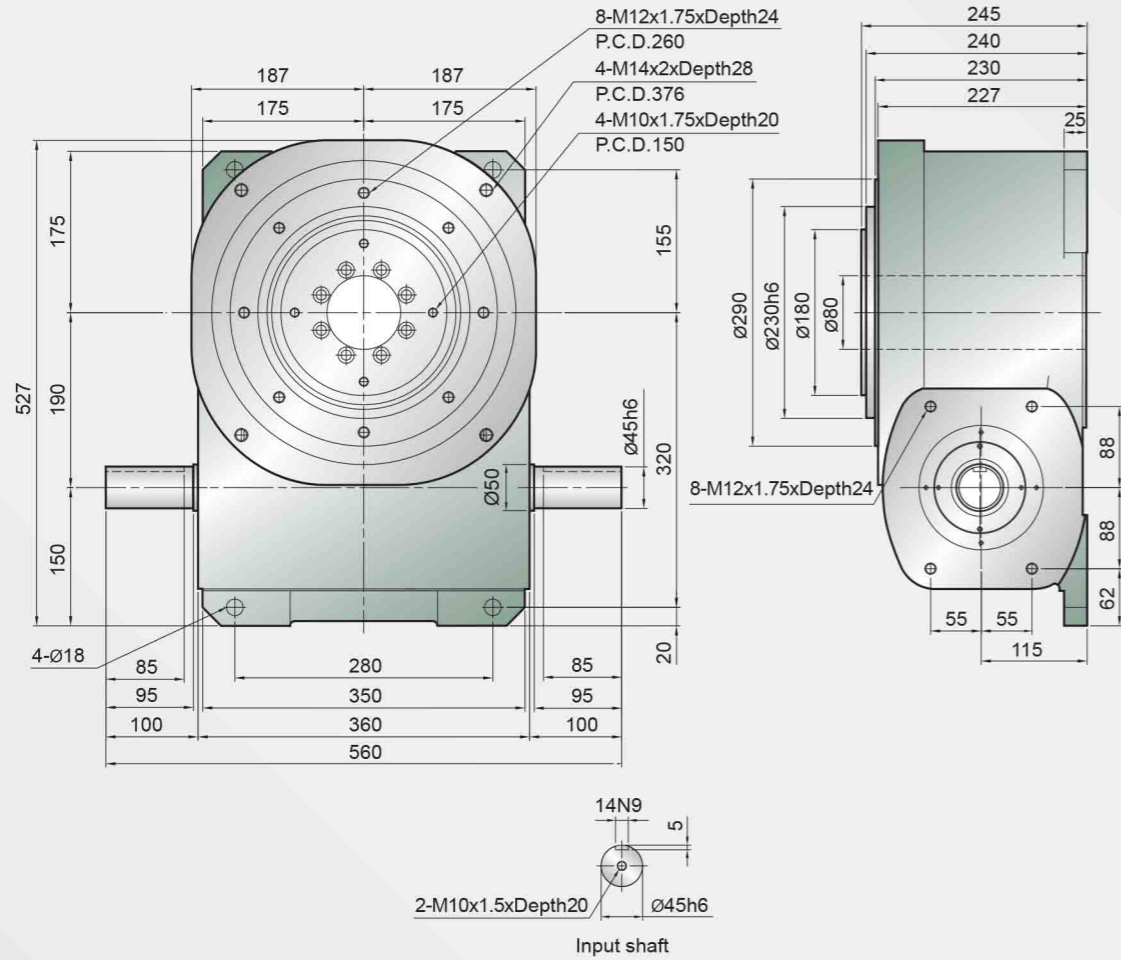

Item	Sym-bol	Unit	Value
Allowable thrust load on output shaft	C1	kgf	1838
Allowable radial load on output shaft	C2	kgf	918
Allowable torque on output shaft	Ts	kgf-m	Refer torque table
Allowable thrust load on input shaft	C3	kgf	510
Max. repetitive bending force on input shaft	C4	kgf	510
Max. repetitive torque on input shaft	C5	kgf-m	61
GD ² of input shaft (Note1)	C6	kgf-m ²	0.105
Indexing accuracy		sec.	±30
Weight		kg	180

Notes
1) GD² of input shaft is a value in dwell range.
2) Value of C1 to C5 are those obtained for safety factor=2.

Item	Sym-bol	Unit	Value
Allowable thrust load on output shaft	C1	kgf	2800
Allowable radial load on output shaft	C2	kgf	1300
Allowable torque on output shaft	Ts	kgf-m	Refer torque table
Allowable thrust load on input shaft	C3	kgf	650
Max. repetitive bending force on input shaft	C4	kgf	650
Max. repetitive torque on input shaft	C5	kgf-m	80
GD ² of input shaft (Note1)	C6	kgf-m ²	0.136
Indexing accuracy		sec.	±30
Weight		kg	285

Notes
1) GD² of input shaft is a value in dwell range.
2) Value of C1 to C5 are those obtained for safety factor=2.